

**GALVA, KANSAS  
VICINITY MAP**  
(NOT DRAWN TO SCALE)

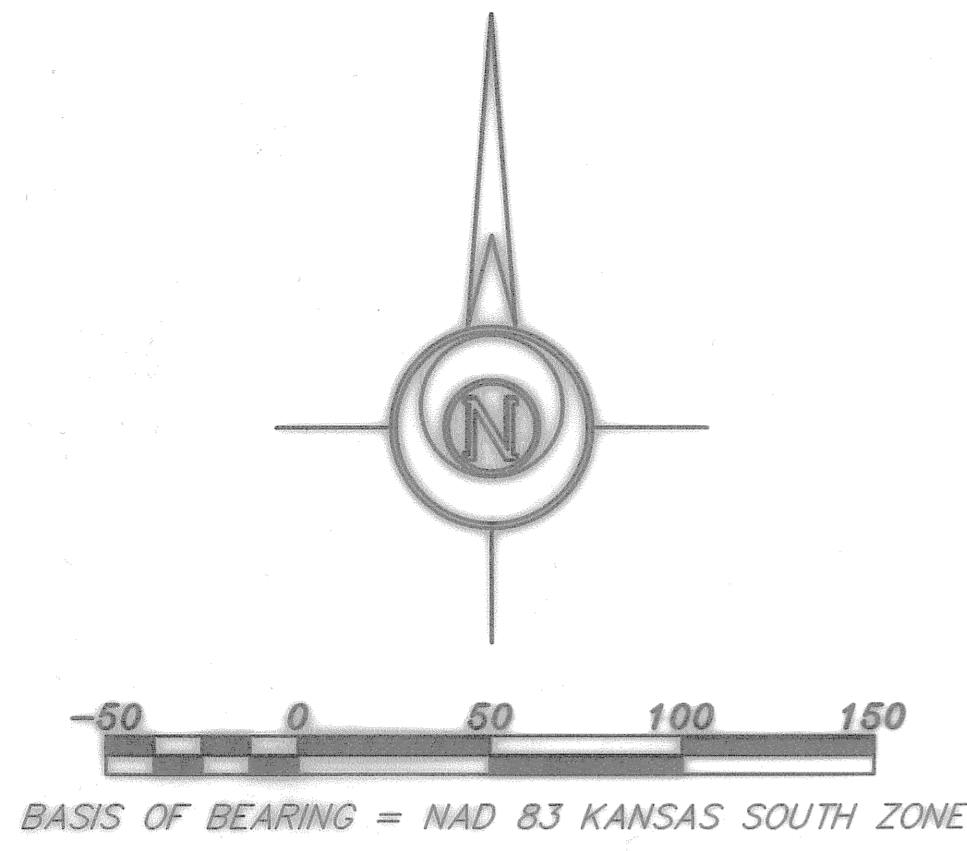

- LEGEND**
- △ - Sectional Monument Found
  - - Survey Monument Found
  - 5/8" x 24" Iron Rebar Set w/G.S.S. Cap
  - 5/8" Rebar Set in Concrete
  - (C) - Calculated
  - (M) - Measured
  - (PL) - Platted
  - (PS) - Previous Survey (GSS G2006-811)
  - (R) - Record measurement
  - P.O.B. - Point of Beginning
  - P.O.C. - Point of Commencement

**CLOSURE TABLE**

NORTHING: 0.00310  
EASTING: -0.00452  
PRECISION: 1/501.73/0.0055 = 1:273,041.82

FINAL PLAT

# WOODBURY ADDITION

A PORTION OF THE SOUTHWEST QUARTER OF SECTION 22, TOWNSHIP 19 SOUTH, RANGE 2 WEST OF THE 6TH PRINCIPAL MERIDIAN, IN GALVA, McPHERSON COUNTY, KANSAS.

**LAND SURVEYOR'S CERTIFICATE AND DESCRIPTION**

I, the undersigned licensed land surveyor of the State of Kansas, do hereby certify that the following described tract of land was surveyed on September 5, 2014 and the accompanying final plat prepared and that all monuments shown herein actually exist and their positions are correctly shown to the best of my knowledge and belief.

A portion of the Southwest Quarter of the Southwest Quarter of Section 22, Township 19 South, Range 2 West of the 6th Principal Meridian, McPherson County, Kansas more particularly described as follows:  
Commencing at the Southwest corner of the Southwest Quarter of Section 22, Township 19 South, Range 2 West of the 6th Principal Meridian, thence North 90°00'00" East along the South line of said Southwest Quarter 813.00 feet; thence North 00°31'37" East, 75.03 feet; thence North 00°34'10" East, 208.71 for the point of beginning; thence continuing North 00°34'10" East, 386.00 feet to the South line of 5th Street; thence South 89°22'01" East along the South line of 5th Street 367.50 feet; thence South 01°17'48" West 385.62 feet; thence North 89°25'50" West 362.61 feet to the point of beginning, containing **3.233 Acres**, subject to any easements or restrictions of record.

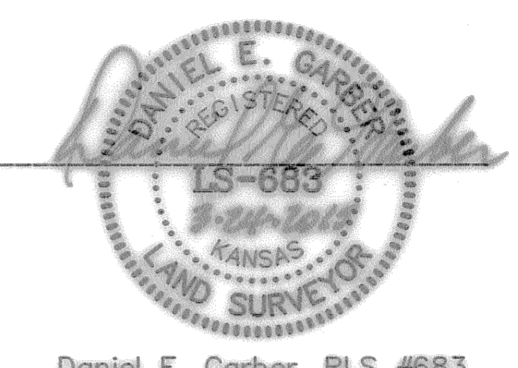

Date March 24, 2015.

- C2**  
Delta=35°54'11"  
R=100.00  
L=62.88  
T=32.40  
C=61.64 N 19°29'58" E
- C3**  
Delta=111°40'18"  
R=45.00  
L=195.04  
T=66.30  
C=74.47 S 54°41'50" E
- C4**  
Delta=68°53'52"  
R=17.50  
L=21.04  
T=12.00  
C=19.80 N 35°01'06" E

**EASEMENTS**

Easements are hereby dedicated to the public, the rights-of-way of which are shown as dashed lines on the accompanying plat, and said easements may be employed in perpetuity as a covenant running with the land for the purpose of installing, repairing, reinstalling, replacing and maintaining sewers, water lines, electric lines and poles, telephone lines and poles and other forms and types of public utilities now or hereafter generally utilized by the public.

**STREETS**

Streets shown on this plat and not heretofore dedicated to the public are hereby so dedicated.

**BUILDING LINES**

Building lines or setback lines are hereby established as shown on the accompanying plat and no building or portion thereof shall be built or constructed between this line and the street line. Building setback this plat shall be 25.00 feet except where shown otherwise on plat, measured at right angles to the street.

**OWNER'S CERTIFICATE AND DEDICATION**

STATE OF KANSAS }  
COUNTY OF McPHERSON } SS

This is to certify that the undersigned owner(s) of the land described in the Land Surveyor's Certificate, have caused the same to be surveyed and subdivided on the accompanying plat into lots, blocks, streets and other public areas under the name of **WOODBURY ADDITION**, that all roads, alleys, easements and public grounds as denoted on the plat are hereby dedicated to and for the use of the public, or to those denoted hereon, for the purpose of constructing, operating, maintaining and repairing public improvements; and further that the land contained herein is held and shall be conveyed subject to any applicable restrictions, reservations and covenants now on file or hereafter filed in the Office of the Register of Deeds of McPherson County, Kansas.

Date Signed: 3-24-2015

HEARTLAND DEVELOPERS, LLC  
Ario J. Unruh      Wayne Troyer      Merrill Rempel

**NOTARY CERTIFICATE**

STATE OF KANSAS }  
COUNTY OF McPHERSON } SS

**BE IT REMEMBERED:**  
That on this 24th day of March, 2015 A.D., before me, the undersigned, a notary public in and for the county and state aforesaid, came Ario J. Unruh, Wayne Troyer, and Merrill Rempel, members of Heartland Ventures, who are known to me to be the same persons who executed the foregoing plat and the within instrument of writing.

**IN TESTIMONY WHEREOF:**  
I have hereunto set my hand and affixed my Notarial Seal the day and year last mentioned above.  
My Commission Expires: 10-19-18

Michelle Unruh Notary Public

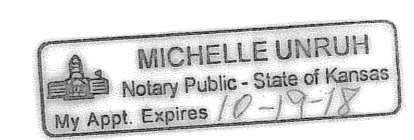

*11-16-15 Dec of Covenant Book 662-6461*  
*10-2-15 Amend Covenant Book 669-17444*

**COUNTY SURVEYOR'S CERTIFICATE**

STATE OF KANSAS }  
COUNTY OF McPHERSON } SS

Reviewed by the Unified Government Surveyor this 30th day of March, 2015. This survey has been reviewed for filing, pursuant to K.S.A. 58-2005 and K.S.A. 58-2011 for content only and is in compliance with those provisions. No other warranties are extended or implied.

William B. Heller  
William B. Heller, RLS #1202, County Surveyor

**COUNTY CLERK AND CITY CLERK CERTIFICATE**

STATE OF KANSAS }  
COUNTY OF McPHERSON } SS  
CITY OF GALVA

We, the undersigned, County Clerk of McPherson County, Kansas and City Clerk of the City of Galva, Kansas, within our respective jurisdictions, do hereby certify that at the date of this certificate, all currently due and owing taxes and special assessments of any kind assessed against any of the land included in this plat, have been paid.

Date Signed: Apr. 3, 2015

Date Signed: March 24, 2015

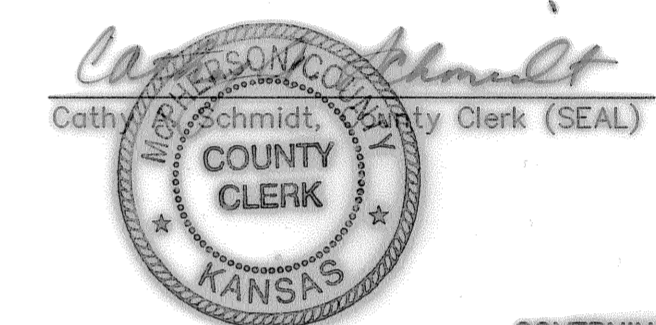

Lori Tector  
Lori Tector, City Clerk (SEAL)

**GOVERNING BODY CERTIFICATE**

STATE OF KANSAS }  
CITY OF GALVA } SS

The dedications shown on this plat, if any, are hereby accepted by the Governing Body of the City of Galva, Kansas, on March 24, 2015.

Wayne H. Ford  
Wayne H. Ford, Mayor

Lori Tector  
Lori Tector, City Clerk

**TRANSFER RECORD**

Entered in the public record this 3rd day of April, 2015.



**CITY ATTORNEY'S CERTIFICATE**

STATE OF KANSAS }  
CITY OF GALVA } SS

This plat is approved pursuant to the provisions of K.S.A. 12-401.

Date Signed: 3-24-15  
Harry Weelborg, City Attorney

**REGISTER OF DEEDS CERTIFICATE**

State of Kansas, McPherson Co., SS  
This instrument was filed for record on the 24th day of April, A.D. 2015, at 5:00 P.M. and is correct and true in all respects.  
Plat C. 50



<b>FINAL PLAT</b>		Description: <b>WOODBURY ADDITION McPHERSON COUNTY, KANSAS</b>	
Prepared By: <b>Garber Surveying Service, P.A.</b>			
<b>HUTCHINSON (Main Office)</b> 2908 North Plum St. 67502 Ph. 620-665-7032 Fax 620-663-7401 <b>McPHERSON (Branch Office)</b> 115 East Main 67460 Ph. 620-241-4441 Fax 620-241-4458 <b>NEWTON (Branch Office)</b> 511 North Poplar St. 67114 Ph. 316-283-5953 Fax 316-283-5073			
Drawn By: JAK	Scale: 1"=50'	Date of Field Work: June 25, 2014	Job No:
Checked By: DEG	Date: 01/22/2015	Sheet 1 of 1 Sheet(s)	G2014-421

Saved: 3/24/2015 7:43:37 AM by ALDPEZ